

版本 REV.	日期 DATE	ECN NO.	变更内容 DESCRIPTION	制图 DRAWN

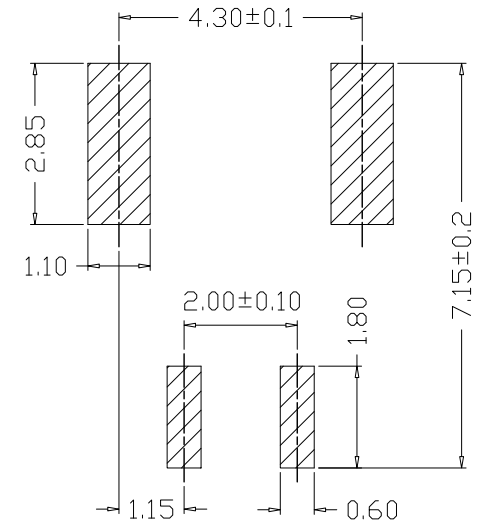

PCB LAYOUT

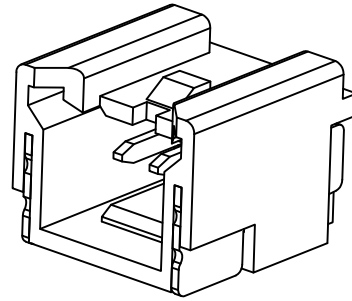
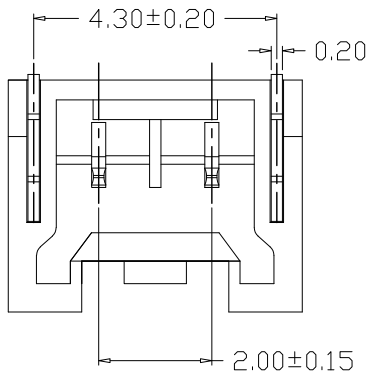
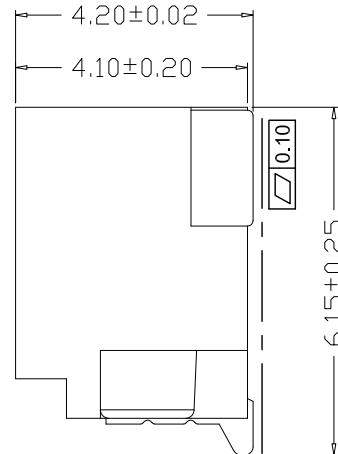
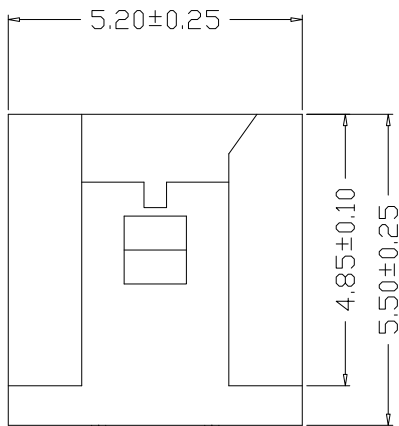

SPECIFICATIONS

- 1、Current Rating: 1A AC, DC
- 2、Voltage Rating: 125V AC, DC
- 3、Temperatuer Range: -25°C~+85°C
- 4、Contact Resistance: 20mΩ Max
- 5、Insulation Resistance: 100MΩ Min
- 6、Withstanding Voltang: 500V AC/minute
- 7、Material:  
Wafer PA6T, UL94V-0  
PIN Brass Tin-plated  
Fixing piece: Phosphor bronze Tin-plated

0.25±0.05

GENREL TOLERANCE		制图 Mapping	张迎春 2022、08、26	料号 PART NO.	B10016-2AWB	版本 REV.	A
X±0.25	X°±2°	审核 Audit	钱岳生 2022、08、27	品名 TITLE	10033卧贴 WAFER SMT TYPE	页次 SHEET	1/1
.X±0.25	.X°±1°	核准 Approved	张名 2023、08、27	客户料号 CUTM. NO.			
.XX±0.15	.XX°±0.5°	单位 Units	mm	比例 SCALE			
.XXX±0.10	.XXX°±0.5°			<b>乐清市宏一电子有限公司</b> Yueqing HongYi Electronics Co., Ltd			